

REVISIONS

LTR	DESCRIPTION	DATE (YR-MO-DA)	APPROVED



REV																				
SHEET																				
REV																				
SHEET																				

REV STATUS OF SHEETS	REV																			
	SHEET	1	2	3	4	5	6	7	8	9	10	11								

PMIC N/A	PREPARED BY Steve L. Duncan	<p align="center">DLA LAND AND MARITIME COLUMBUS, OHIO 43218-3990 http://www.dla.mil/landandmaritime</p>																	
<p align="center">STANDARD MICROCIRCUIT DRAWING</p> <p align="center">THIS DRAWING IS AVAILABLE FOR USE BY ALL DEPARTMENTS AND AGENCIES OF THE DEPARTMENT OF DEFENSE</p> <p align="center">AMSC N/A</p>	CHECKED BY Greg Cecil																		
	APPROVED BY Charles F. Saffle	<p align="center">MICROCIRCUIT, HYBRID, SINGLE/DUAL CHANNEL, DC/DC CONVERTER</p>																	
	DRAWING APPROVAL DATE 18-06-07																		
	REVISION LEVEL	SIZE A	CAGE CODE 67268	5962-18206															
		SHEET		1 OF 11															

DSCC FORM 2233
APR 97

5962-E363-18

DISTRIBUTION STATEMENT A. Approved for public release. Distribution is unlimited.

1. SCOPE

1.1 Scope. This drawing documents five product assurance classes as defined in paragraph 1.2.3 and MIL-PRF-38534. A choice of case outlines and lead finishes which are available and are reflected in the Part or Identifying Number (PIN). When available, a choice of radiation hardness assurance levels are reflected in the PIN.

1.2 PIN. The PIN is as shown in the following example:

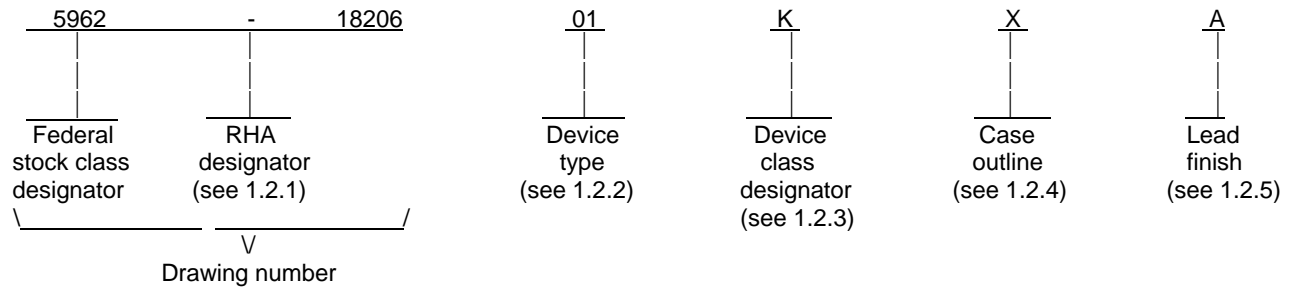

1.2.1 Radiation hardness assurance (RHA) designator. RHA marked devices meet the MIL-PRF-38534 specified RHA levels and are marked with the appropriate RHA designator. A dash (-) indicates a non-RHA device.

1.2.2 Device type(s). The device type(s) identify the circuit function as follows:

<u>Device type</u>	<u>Generic number</u>	<u>Circuit function</u>
01	10553FM	DC/DC Converter, 30 W, ±5 V Output
02	10554FM	DC/DC Converter, 30 W, +7.7 V Output

1.2.3 Device class designator. This device class designator is a single letter identifying the product assurance level. All levels are defined by the requirements of MIL-PRF-38534 and require QML Certification as well as qualification (Class H, K, and E) or QML Listing (Class G and D). The product assurance levels are as follows:

<u>Device class</u>	<u>Device performance documentation</u>
K	Highest reliability class available. This level is intended for use in space applications.
H	Standard military quality class level. This level is intended for use in applications where non-space high reliability devices are required.
G	Reduced testing version of the standard military quality class. This level uses the Class H screening and In-Process Inspections with a possible limited temperature range, manufacturer specified incoming flow, and the manufacturer guarantees (but may not test) periodic and conformance inspections (Group A, B, C and D).
E	Designates devices which are based upon one of the other classes (K, H, or G) with exception(s) taken to the requirements of that class. These exception(s) must be specified in the device acquisition document; therefore the acquisition document should be reviewed to ensure that the exception(s) taken will not adversely affect system performance.
D	Manufacturer specified quality class. Quality level is defined by the manufacturers internal, QML certified flow. This product may have a limited temperature range.

STANDARD MICROCIRCUIT DRAWING DLA LAND AND MARITIME COLUMBUS, OHIO 43218-3990	SIZE A		5962-18206
		REVISION LEVEL	SHEET 2

1.2.4 Case outline(s). The case outline is as designated in MIL-STD-1835 and as follows:

<u>Outline letter</u>	<u>Descriptive designator</u>	<u>Terminals</u>	<u>Package style</u>
X	See Figure 1	8	Straight leads with side mounting through holes

1.2.5 Lead finish. The lead finish is as specified in MIL-PRF-38534.

1.3 Absolute maximum ratings. ^{1/}

Input voltage range	-0.5 V dc to +60 V dc (continuous)
Lead temperature (soldering, 10 seconds).....	+300°C
Storage temperature range.....	-55°C to +135°C

1.4 Recommended operating conditions.

Input voltage range	+19 V dc to +53 V dc
Output Power	≤ 30W
Case operating temperature range (Tc).....	-55°C to +85°C

2. APPLICABLE DOCUMENTS

2.1 Government specification, standards, and handbooks. The following specification, standards, and handbooks form a part of this drawing to the extent specified herein. Unless otherwise specified, the issues of these documents are those cited in the solicitation or contract.

DEPARTMENT OF DEFENSE SPECIFICATIONS

MIL-PRF-38534 - Hybrid Microcircuits, General Specification for.

DEPARTMENT OF DEFENSE STANDARDS

MIL-STD-883 - Test Method Standard Microcircuits.
 MIL-STD-1835 - Interface Standard for Electronic Component Case Outlines.

DEPARTMENT OF DEFENSE HANDBOOKS

MIL-HDBK-103 - List of Standard Microcircuit Drawings.
 MIL-HDBK-780 - Standard Microcircuit Drawings.

(Copies of these documents are available online at <http://quicksearch.dla.mil>)

2.2 Order of precedence. In the event of a conflict between the text of this drawing and the references cited herein, the text of this drawing takes precedence. Nothing in this document, however, supersedes applicable laws and regulations unless a specific exemption has been obtained.

^{1/} Stresses above the absolute maximum ratings may cause permanent damage to the device. Extended operation at the maximum levels may degrade performance and affect reliability.

STANDARD MICROCIRCUIT DRAWING DLA LAND AND MARITIME COLUMBUS, OHIO 43218-3990	SIZE A		5962-18206
		REVISION LEVEL	SHEET 3

3. REQUIREMENTS

3.1 Item requirements. The individual item performance requirements for device classes D, E, G, H, and K shall be in accordance with MIL-PRF-38534 as specified herein. Compliance with MIL-PRF-38534 shall include the performance of all tests herein or as designated in the device manufacturer's Quality Management (QM) plan or as designated for the applicable device class. The manufacturer may eliminate, modify, or optimize the tests and inspections herein; however, the performance requirements as defined in MIL-PRF-38534 shall be met for the applicable device class. In addition, the modification in the QM plan shall not affect the form, fit, or function of the device for the applicable device class.

3.2 Design, construction, and physical dimensions. The design, construction, and physical dimensions shall be as specified in MIL-PRF-38534 and herein.

3.2.1 Case outline(s). The case outline(s) shall be in accordance with 1.2.4 herein and figure 1.

3.2.2 Terminal connections. The terminal connections shall be as specified on figure 2.

3.3 Electrical performance characteristics. Unless otherwise specified herein, the electrical performance characteristics are as specified in table I and shall apply over the full specified operating temperature range.

3.4 Electrical test requirements. The electrical test requirements shall be the subgroups specified in table II. The electrical tests for each subgroup are defined in table I.

3.5 Marking of device(s). Marking of device(s) shall be in accordance with MIL-PRF-38534. The device shall be marked with the PIN listed in 1.2 herein. In addition, the manufacturer's vendor similar PIN may also be marked.

3.6 Data. In addition to the general performance requirements of MIL-PRF-38534, the manufacturer of the device described herein shall maintain the electrical test data (variables format) from the initial quality conformance inspection group A lot sample, for each device type listed herein. Also, the data should include a summary of all parameters manually tested, and for those which, if any, are guaranteed. This data shall be maintained under document revision level control by the manufacturer and be made available to the preparing activity (DLA Land and Maritime -VA) upon request.

3.7 Certificate of compliance. A certificate of compliance shall be required from a manufacturer in order to supply to this drawing. The certificate of compliance (original copy) submitted to DLA Land and Maritime -VA shall affirm that the manufacturer's product meets the performance requirements of MIL-PRF-38534 and herein.

3.8 Certificate of conformance. A certificate of conformance as required in MIL-PRF-38534 shall be provided with each lot of microcircuits delivered to this drawing.

4. VERIFICATION

4.1 Sampling and inspection. Sampling and inspection procedures shall be in accordance with MIL-PRF-38534 or as modified in the device manufacturer's Quality Management (QM) plan. The modification in the QM plan shall not affect the form, fit, or function as described herein.

STANDARD MICROCIRCUIT DRAWING DLA LAND AND MARITIME COLUMBUS, OHIO 43218-3990	SIZE A		5962-18206
		REVISION LEVEL	SHEET 4

TABLE I. Electrical performance characteristics.

Test	Symbol	Conditions -55°C ≤ T _C ≤ +85°C V _{IN} = 28 V DC ± 5%, C _L = 0 unless otherwise specified	Group A subgroups	Device type	Limits		Unit
					Min	Max	
Input Voltage	V _{IN}			01, 02	19	53	V
Output Voltage	V _{OUT}	V _{in} = 28 V, 100% load on both outputs	1	01	±4.95	±5.05	V
			2, 3		±4.90	±5.10	
		V _{in} = 28 V, 100% load	1	02	7.62	7.78	
			2, 3		7.54	7.85	
Output Current <u>1/ 2/</u>	I _{OUT}	V _{IN} = 19, 28, 53 V dc, Either output	1, 2, 3	01		4.8	A
		V _{IN} = 19, 28, 53 V dc		02		2.9	
Output Power <u>1/ 2/</u>	P _{OUT}	V _{IN} = 19, 28, 53 V dc	1, 2, 3	01, 02		30	W
Output Ripple Voltage <u>1/ 3/</u>	V _{RIP}	V _{IN} = 19, 28, 53 V dc, I _{OUT} = 100% load, BW = 20 Hz to 2 MHz	1, 2, 3	01		80	mV p-p
				02		70	
Line Regulation <u>3/</u>	V _{RLINE}	V _{IN} = 19, 28, 53 V dc, I _{OUT} = 50 mA, 50%, 100% load	1, 2, 3	01, 02	-0.5	+0.5	%
Load Regulation <u>3/</u>	V _{RLOAD}	V _{IN} = 19, 28, 53 V dc, I _{OUT} = 50 mA, 50%, 100% load	1, 2, 3	01, 02	-1.0	+1.0	%
Cross Regulation <u>4/</u>	V _{RCROSS}	V _{IN} = 19, 28, 53 V dc	1, 2, 3	01	-5.0	+5.0	%
Input Current	I _{IN}	I _{OUT} = 0 A, Pin 4 open	1, 2, 3	01, 02		70	mA
		I _{OUT} = 0 A, Pin 4 open, V _{IN} = 53 V	1, 2, 3	01, 02		40	mA
		Pin 4 shorted to Pin 2	1, 2, 3	01, 02		8	mA
Efficiency <u>3/</u>	E _{EFF}	I _{OUT} = 100% load	1, 2, 3	01	79		%
				02	78		

See footnotes at end of table.

STANDARD MICROCIRCUIT DRAWING DLA LAND AND MARITIME COLUMBUS, OHIO 43218-3990	SIZE A		5962-18206
		REVISION LEVEL	SHEET 5

TABLE I. Electrical performance characteristics - Continued.

Test	Symbol	Conditions -55°C ≤ T _C ≤ +85°C V _{IN} = 28 V DC ± 5%, C _L = 0 unless otherwise specified	Group A subgroups	Device type	Limits		Unit
					Min	Max	
Isolation	ISO	Input to Output or any Pin to Case except Pin 3 at 500 V dc	1	01, 02	100		MΩ
Maximum Capacitive Load <u>5/ 6/</u>	C _L	I _{OUT} = 100% load, Each Output	1	01		500	μF
				02		750	
Power Dissipation Load Fault	P _D	Short Circuit, Overload	1, 2, 3	01, 02		14	W
Current Limit Point	I _{LIM}	V _{OUT} = 90% of Nominal	4, 5, 6	01, 02	105	145	%
Switching Frequency	F _S	100% Load	4, 5, 6	01, 02	425	575	kHz
Line Rejection <u>1/ 3/ 6/</u>	REJ	100% Load, DC to 50 kHz	1	01, 02	35		dB
Enable Input (Inhibit) <u>6/</u> Open circuit voltage Drive current (sink) Voltage range	ENB			01, 02	9 0 -0.5	12 5.0 50	V mA V
Output response to step load changes <u>3/ 7/</u>	V _{TLD}	50% to/from 100% Load	4, 5, 6	01, 02	-300	300	mV pk
Recovery time, step load changes <u>3/ 7/ 8/</u>	T _{TLD}	50% to/from 100% Load	4, 5, 6	01, 02		200	μs
Output response to step line changes <u>3/ 6/ 9/</u>	V _{TLN}	Input Step 18 V to/from 40 V, I _{OUT} = 100% load	4, 5, 6	01, 02	-300	300	mV pk
Recovery time, step line changes <u>3/ 6/ 9/</u>	T _{TLN}	Input Step 18 V to/from 40 V, I _{OUT} = 100% load	4, 5, 6	01, 02		200	μs
Turn-On overshoot <u>3/ 10/</u>	V _{OS}	10% Load, 100% Load	4, 5, 6	01		500	mV
				02		700	
Turn-On Delay <u>3/ 10/</u>	T _{DLY}	10% Load, 100% Load	4, 5, 6	01, 02		10	mS

See footnotes at end of table.

**STANDARD
MICROCIRCUIT DRAWING**

DLA LAND AND MARITIME
COLUMBUS, OHIO 43218-3990

SIZE
A

REVISION LEVEL

5962-18206

SHEET

6

TABLE I. Electrical performance characteristics - Continued.

- 1/ Applicable to positive and negative outputs.
- 2/ Output load current must be distributed such that at least 20% of the total load current is being provided by one of the outputs.
- 3/ Load current split equally between +V_{OUT} and -V_{OUT}.
- 4/ Cross regulation is measured with 20% rated load on output under test while changing the load on the other output from 20% to 80% of rated.
- 5/ Capacitive load may be any value from 0 to the maximum limit without compromising DC performance.
- 6/ Parameter is tested as part of design characterization or after design changes. Thereafter, parameter shall be guaranteed to the limits specified.
- 7/ Load step transition time ≤ 10 μs.
- 8/ Recovery time is measured from the initiation of the transient to where V_{OUT} has returned to within ±1% of its steady state value at 50% load.
- 9/ Input line step transition time ≤ 100 μs.
- 10/ Turn-on delay time from either a step application of input power or a logic low to logic high transition on the enable pin.

STANDARD MICROCIRCUIT DRAWING DLA LAND AND MARITIME COLUMBUS, OHIO 43218-3990	SIZE A		5962-18206
		REVISION LEVEL	SHEET 7

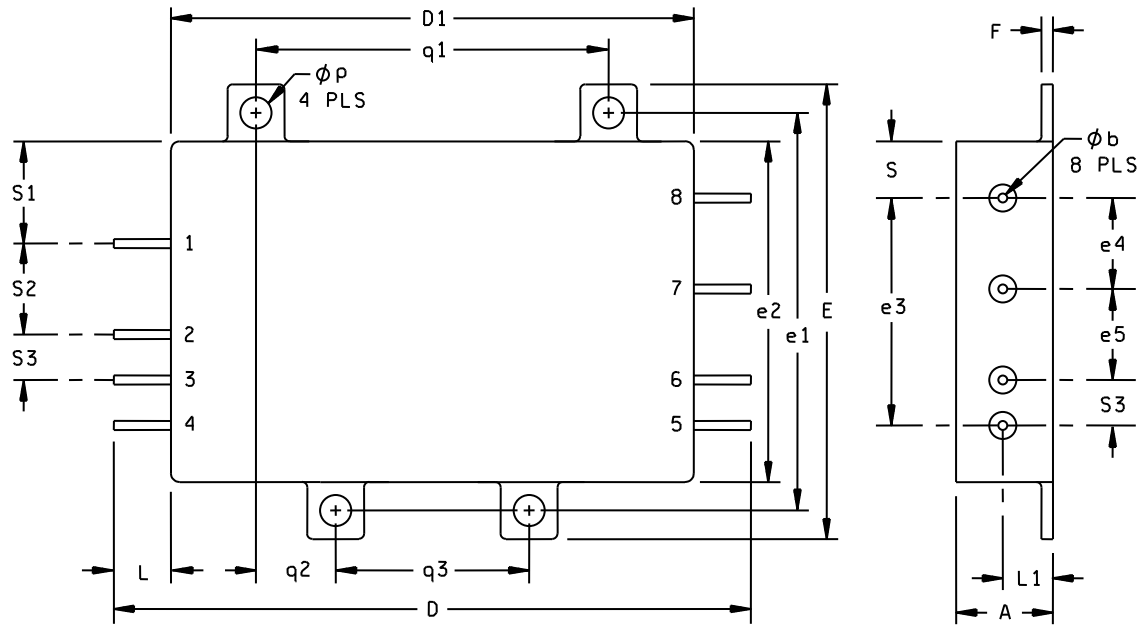

Symbol	Millimeters		Inches	
	Min	Max	Min	Max
A		10.80		.425
D	70.87	71.37	2.79	2.81
D1	58.29	58.55	2.295	2.305
E	50.67	50.93	1.995	2.005
e1	44.32	44.58	1.745	1.755
e2	37.97	38.23	1.495	1.505
e3	25.27	25.53	.995	1.005
e4/e5/S2	10.03	10.29	.395	.405
F	1.14	1.40	.045	.055
L	6.22	6.48	.245	.255
L1	5.46	5.72	.215	.225
q1	39.24	39.50	1.545	1.555
q2	8.76	9.02	.345	.355
q3	21.46	21.72	.845	.855
S	6.73	6.99	.265	.275
S1	11.81	12.07	.465	.475
S3	4.95	5.21	.195	.205
phi b	0.89	1.14	.035	.045
phi p	3.38	3.63	.133	.143

NOTES:

1. The US government preferred system of measurement is the metric SI. This item was designed using inch-pound units of measurement. In case of problems involving conflicts between the metric and inch-pound units, the inch-pound units shall rule.
2. Case outline weight: 80 grams maximum.

FIGURE 1. Case outline.

STANDARD MICROCIRCUIT DRAWING DLA LAND AND MARITIME COLUMBUS, OHIO 43218-3990	SIZE A		5962-18206
		REVISION LEVEL	SHEET 8

Device Type	01
Terminal number	Terminal Symbol
1	Positive Input
2	Input Return
3	Case Ground
4	Enable
5	Output Adjust
6	Negative Output
7	Output Common
8	Positive Output

Device Type	02
Terminal number	Terminal Symbol
1	Positive Input
2	Input Return
3	Case Ground
4	Enable
5	Output Adjust
6	Output Return
7	Positive Output
8	Not Connected

FIGURE 2. Terminal connections.

STANDARD MICROCIRCUIT DRAWING DLA LAND AND MARITIME COLUMBUS, OHIO 43218-3990	SIZE A		5962-18206
		REVISION LEVEL	SHEET 9

TABLE II. Electrical test requirements.

MIL-PRF-38534 test requirements	Subgroups (in accordance with MIL-PRF-38534, group A test table)
Interim electrical parameters	1, 4
Final electrical parameters	1*, 2, 3, 4, 5, 6
Group A test requirements	1, 2, 3, 4, 5, 6
Group C end-point electrical parameters	1, 2, 3, 4, 5, 6
End-point electrical parameters for Radiation Hardness Assurance (RHA) devices	Not applicable

* PDA applies to subgroup 1.

4.2 Screening. Screening shall be in accordance with MIL-PRF-38534. The following additional criteria shall apply:

a. Burn-in test, method 1015 of MIL-STD-883.

- (1) Test condition A, B, C, or D. The test circuit shall be maintained by the manufacturer under document revision level control and shall be made available to either DLA Land and Maritime -VA or the acquiring activity upon request. Also, the test circuit shall specify the inputs, outputs, biases, and power dissipation, as applicable, in accordance with the intent specified in test method 1015 of MIL-STD-883.
- (2) T_A as specified in accordance with table I of method 1015 of MIL-STD-883.

b. Interim and final electrical test parameters shall be as specified in table II herein, except interim electrical parameter tests prior to burn-in are optional at the discretion of the manufacturer.

4.3 Conformance and periodic inspections. Conformance inspection (CI) and periodic inspection (PI) shall be in accordance with MIL-PRF-38534 and as specified herein.

4.3.1 Group A inspection (CI). Group A inspection shall be in accordance with MIL-PRF-38534 and as follows:

a. Tests shall be as specified in table II herein.

4.3.2 Group B inspection (PI). Group B inspection shall be in accordance with MIL-PRF-38534.

STANDARD MICROCIRCUIT DRAWING DLA LAND AND MARITIME COLUMBUS, OHIO 43218-3990	SIZE A		5962-18206
		REVISION LEVEL	SHEET 10

4.3.3 Group C inspection (PI). Group C inspection shall be in accordance with MIL-PRF-38534 and as follows:

- a. End-point electrical parameters shall be as specified in table II herein.
- b. Steady-state life test, method 1005 of MIL-STD-883.
 - (1) Test condition A, B, C, or D. The test circuit shall be maintained by the manufacturer under document revision level control and shall be made available to either DLA Land and Maritime -VA or the acquiring activity upon request. Also, the test circuit shall specify the inputs, outputs, biases, and power dissipation, as applicable, in accordance with the intent specified in test method 1005 of MIL-STD-883.
 - (2) T_A as specified in accordance with table I of method 1005 of MIL-STD-883.
 - (3) Test duration: 1,000 hours, except as permitted by method 1005 of MIL-STD-883.

4.3.4 Group D inspection (PI). Group D inspection shall be in accordance with MIL-PRF-38534.

4.3.5 Radiation Hardness Assurance (RHA) inspection. RHA inspection is not currently applicable to this drawing.

5. PACKAGING

5.1 Packaging requirements. The requirements for packaging shall be in accordance with MIL-PRF-38534.

6. NOTES

6.1 Intended use. Microcircuits conforming to this drawing are intended for use for Government microcircuit applications (original equipment), design applications, and logistics purposes.

6.2 Replaceability. Microcircuits covered by this drawing will replace the same generic device covered by a contractor-prepared specification or drawing.

6.3 Configuration control of SMD's. All proposed changes to existing SMD's will be coordinated as specified in MIL-PRF-38534.

6.4 Record of users. Military and industrial users should inform DLA Land and Maritime when a system application requires configuration control and the applicable SMD to that system. DLA Land and Maritime will maintain a record of users and this list will be used for coordination and distribution of changes to the drawings. Users of drawings covering microelectronic devices (FSC 5962) should contact DLA Land and Maritime-VA, telephone (614) 692-8108.

6.5 Comments. Comments on this drawing should be directed to DLA Land and Maritime-VA, Columbus, Ohio 43218-3990, or telephone (614) 692-1081.

6.6 Sources of supply. Sources of supply are listed in MIL-HDBK-103 and QML-38534. The vendors, listed in MIL-HDBK-103 and QML-38534, have submitted a certificate of compliance (see 3.7 herein) to DLA Land and Maritime-VA and have agreed to this drawing.

STANDARD MICROCIRCUIT DRAWING DLA LAND AND MARITIME COLUMBUS, OHIO 43218-3990	SIZE A		5962-18206
		REVISION LEVEL	SHEET 11

STANDARD MICROCIRCUIT DRAWING BULLETIN

DATE: 18-06-07

Approved sources of supply for SMD 5962-18206 are listed below for immediate acquisition information only and shall be added to MIL-HDBK-103 and QML-38534 during the next revisions. MIL-HDBK-103 and QML-38534 will be revised to include the addition or deletion of sources. The vendors listed below have agreed to this drawing and a certificate of compliance has been submitted to and accepted by DLA Land and Maritime -VA. This information bulletin is superseded by the next dated revisions of MIL-HDBK-103 and QML-38534. DLA Land and Maritime maintains an online database of all current sources of supply <https://landandmaritimeapps.dla.mil/programs/Smcr/>.

Standard microcircuit drawing PIN <u>1/</u>	Vendor CAGE number	Vendor similar PIN <u>2/</u>
5962-1820601KXA	52467	10553FM
5962-1820601KXC	52467	10553FM
5962-1820602KXA	52467	10554FM
5962-1820602KXC	52467	10554FM

- 1/ The lead finish shown for each PIN representing a hermetic package is the most readily available from the manufacturer listed for that part. If the desired lead finish is not listed contact the Vendor to determine its availability.
- 2/ Caution. Do not use this number for item acquisition. Items acquired to this number may not satisfy the performance requirements of this drawing.

Vendor CAGE number

52467

Vendor name and address

International Rectifier HiRel Products, Incorporated
2520 Junction Avenue
San Jose, CA 95134

The information contained herein is disseminated for convenience only and the Government assumes no liability whatsoever for any inaccuracies in the information bulletin.